

# PX 系列离心泵 SERIES CENTRIFUGAL PUMPS



## WORKING CONDITIONS

Max Temperature of Fluid up to +80°C  
Max Pressure 10bar,  
Max Ambient Temperature up to 40°C

## 工作条件:

最高流体温度为80°C  
最大可承受的压力10bar  
最高环境温度40°C

PX series are single stage centrifugal pumps, suitable for agriculture and industrial applications to convey clean liquids and non-aggressive chemical fluids. It's hydraulic characteristic is lowerhead but bigger capacity.

PX 系列为单级叶轮离心水泵, 适用于农户、企事业给排水, 用于输送清水及不具腐蚀性的流体。其水力特性为低扬程大流量。



H m PERFORMANCE CHART AT n=2900r/min 折算到2900r/min时性能

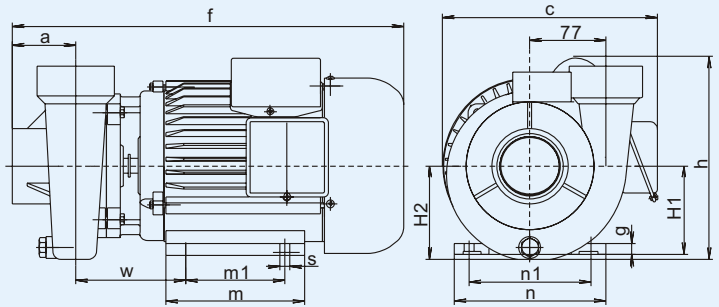
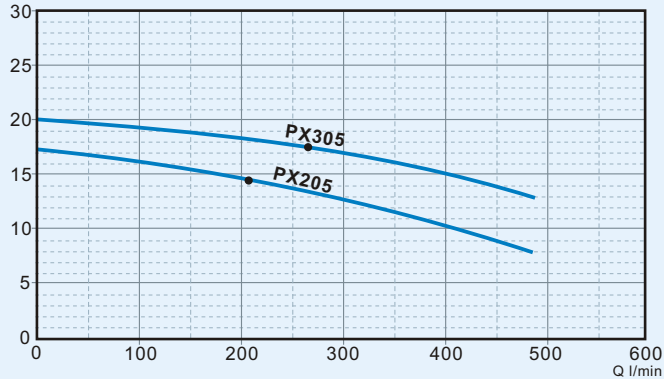

## DIMENSIONS 安装尺寸

| Type<br>型号 | Dimensions 外形尺寸mm |     |     |    |    |    |     |     |     |     |     |     |    | Weight重量 (kg) |      | Packing Size 包装尺寸(mm) |     |     | Packing QTY. 包装数量 |                 |
|------------|-------------------|-----|-----|----|----|----|-----|-----|-----|-----|-----|-----|----|---------------|------|-----------------------|-----|-----|-------------------|-----------------|
|            | a                 | f   | h   | H1 | H2 | l  | c   | m   | m1  | n   | n1  | w   | g  | s             | NW   | GW                    | L   | W   | H                 | 20'Cont<br>20'柜 |
| PX205      | 64                | 395 | 206 | 90 | 95 | 77 | 218 | 140 | 100 | 154 | 125 | 111 | 11 | 10            | 20   | 21.5                  | 440 | 285 | 275               | 700             |
| PX305      | 64                | 395 | 206 | 90 | 95 | 77 | 218 | 140 | 100 | 154 | 125 | 111 | 11 | 10            | 21.5 | 22.8                  | 440 | 285 | 275               | 700             |

## TECHNICAL DATA 技术参数

| TYPE<br>型号 | Output Power 输出功率 |     | Current 电流 (A) | Capacitor 电容器 (F) | H.max 最高扬程 (m) | Q.max 最大流量 (l/min) | Size 进出口径 (inch) | S.Head 最大吸程 (M) | Total head 总扬程 (m) | Capacity 流量 l/min |      |     |     |     |     |     |
|------------|-------------------|-----|----------------|-------------------|----------------|--------------------|------------------|-----------------|--------------------|-------------------|------|-----|-----|-----|-----|-----|
|            | KW                | HP  |                |                   |                |                    |                  |                 |                    | 100               | 150  | 200 | 300 | 400 | 500 | 600 |
| PX205      | 1.1               | 1.5 | 6.6            | 30                | 18             | 480                | 2"X2"            | 8               | Total head 总扬程     | 17                | 15.5 | 14  | 13  | 10  | 6   | -   |
| PX305      | 1.5               | 2   | 8.8            | 40                | 20             | 560                | 2"X2"            | 8               |                    | 20                | 19   | 18  | 17  | 15  | 13  | 8   |

标准的电参数及零件配置: 单相220V/50Hz、铜叶轮、碳钢轴、马达内置热保护器。可根据客户的其它参数及材料的要求, 制作其它单、三相电压、60Hz、双电压、不锈钢轴等规格的产品。  
Standard data and equipment: single phase 220V/50Hz, Brass impeller, carbon steel motor shaft, with terminal protector inside.  
Others model and material such as three phase, 110V, 60Hz, dual voltage, stainless steel shaft, etc, will be available upon request.